

Pump series RMO

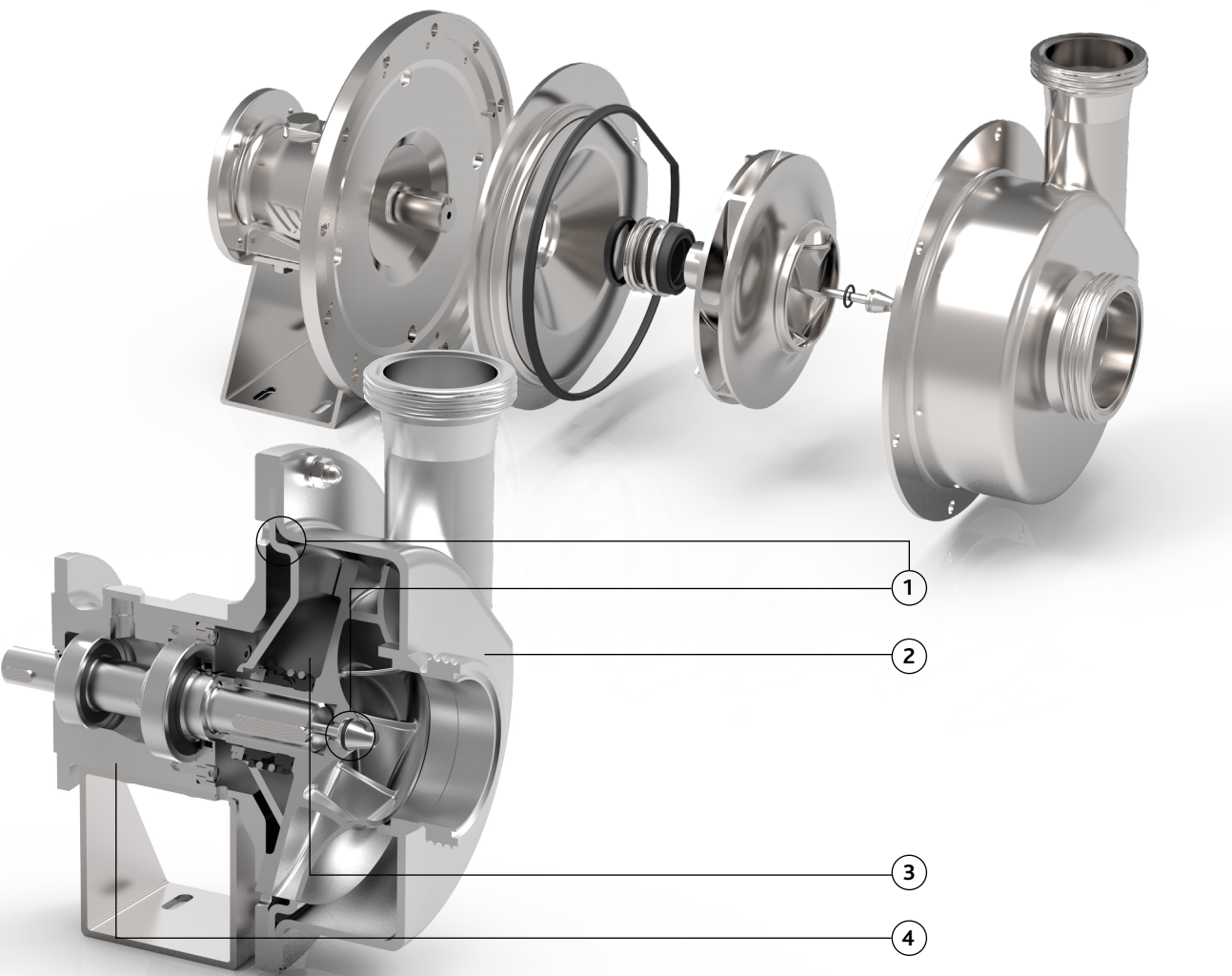

Characteristics

These pump series are especially produced for installation on lorries and trucks and are constructed on a stainless steel bearing pedestal. They can be equipped with an optional hydraulic or electric motor. Pumps provided with an electric motor can be powered by the batteries of the truck and can be executed in a monobloc design. These perfectly cleanable pumps have stainless steel 316L pump casings constructed in thick cold rolled plate, 100% non-porous and extremely smooth. Some of them have an investment cast casing, resulting in an even more solid design.



RMO

- 1. Electropolished, easy to clean construction, no bacteria traps and no small clearances in order to clean the area around the O-rings.
- 2. Pressed or investment cast stainless steel, robust design.
- 3. Large seal cavity to clean mechanical seal properly.
- 4. Cast solid bearing housing with pedestal suitable for hydraulic motor.
- 5. Standardized mechanical seals to EN 12756. FDA approved bellow mechanical seals or sterile O-ring seals (spring not in contact with the liquid).

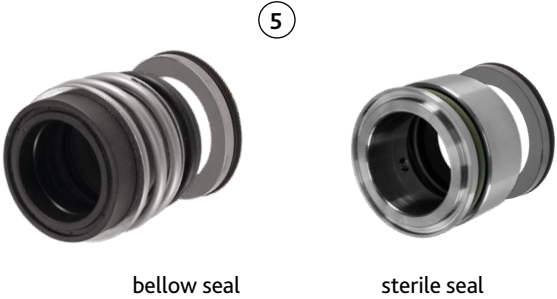





Your benefits

- High pump efficiency, low motor power
- Low NPSH values: less risk on cavitation
- Short built-in dimensions, space saving
- Robust design, smooth operation
- Higher capacity
- Low noise level

Application areas

The RMO series are used on trucks and lorries for the handling of liquids in the food industry such as milk, beer and wine. They can also be used for the handling of AD Blue, drinking water and other liquids.

| Pump series | RMO |
|-------------------------------|---|
| Performance | |
| max. flow rate | 250 m³/h |
| max. differential head | 30 m |
| max. inlet pressure | 10 bar |
| max. liquid viscosity | 1000 cP |
| max. temperature | 140°C |
| impeller type | open / closed |
| max. free passage | 25 mm |
| max. speed | variable |
| Technical specifications | |
| materials wetted parts | 316L or similar |
| mechanical seal configuration | single |
| available material O-ring | EPDM, FKM |
| connections | hygienic fittings |
| surface finish | hygienic quality, internal welds hand polished + electropolished (casing 0.8 µm - impeller 3.2 µm except for MFP series) |
| drive | hydraulic motor or electromotor |
| certificates & legislation |      |

Performance curves for RMO

